

Area a basso rischio "C" frequenza settimanale 6 g./set.		Mq 1183,43
Area a medio rischio "B" frequenza settimanale 7 g./set. con ripasso pomeridiano		Mq 1281,56
Area a medio rischio "B1" frequenza settimanale 5 g./set. con ripasso pomeridiano		Mq 89,50
Area a medio rischio "B2" frequenza settimanale 5 g./set. con quattro ripassi giornalieri		Mq 5,25
Area ad assenza di rischio "D" frequenza settimanale 1 g./set.		Mq 615,15
Area ad alto rischio "A" frequenza settimanale 7 g./set. con ripasso pomeridiano		Mq 474,85
Area ad alto rischio "A1" frequenza settimanale 5 g./set. con ripasso pomeridiano		Mq 88,30

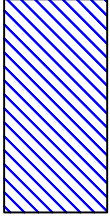
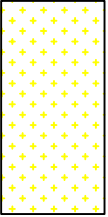
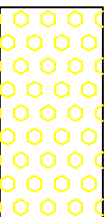
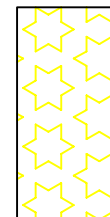
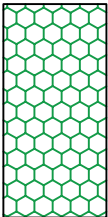
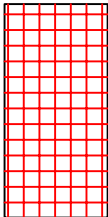
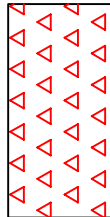
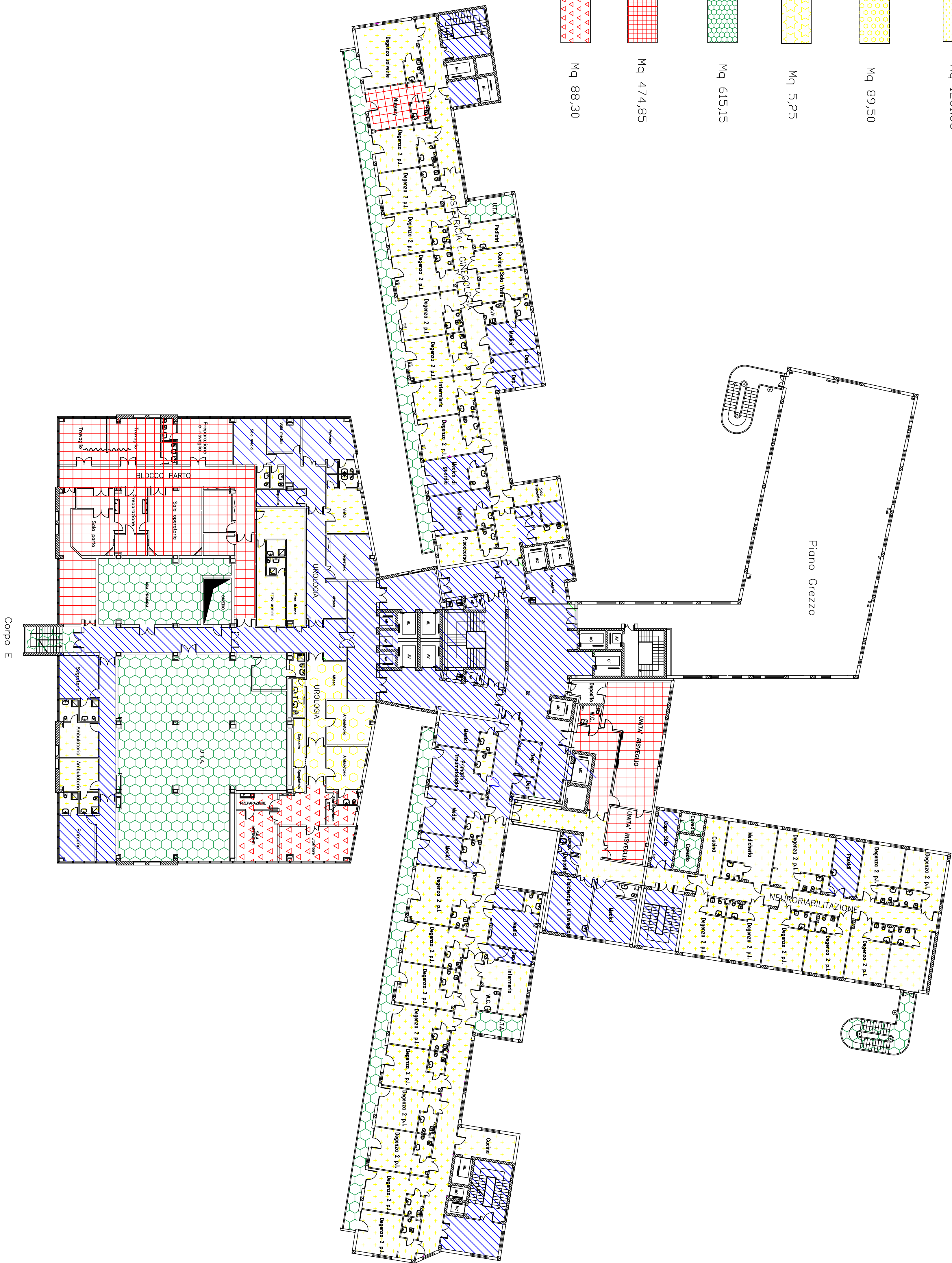

Pianta Quarto - Planimetria classificazione Aree e frequenze